

WATER RESISTANT BONDING

Cold *Bond*

For

Concrete to Concrete, Concrete to Plaster, Tiles & Claddings



ColdBond

Unmatched bonding for Concrete to Concrete, Concrete to Plaster, Tiles & Claddings

THE CHALLENGES

Tile, Marble, Granite & Stone joints experience shrinkage stresses resulting in cracking & de-bonding. They are vulnerable to water entry, which results in delamination of these claddings from its base.

Joint between the old and newly cast part becomes a weak link due to migration of water from newly cast concrete to the cured side.

PCC (Plain Cement Concrete) or RCC (Reinforced Cement Concrete) are cast in parts, leading to joints which develop cracks due to thermal cycling and shrinkage stresses. The junction of PCC or RCC structures with brick walls also has joints which develop cracks. This leads to seepage / leakage.

ABOUT ColdBond

- A new generation of acrylic copolymer technology
- Exhibits dual properties of reactive and acrylic copolymer
- Imparts very high strength through molecular level reactive bonding
- Makes the joining interface water resistant
- Ensures flexible polymeric membrane formation at the interface

This results in formation of a very strong and flexible bond, and creation of monolithic joints.

Boil testing a simulated joint done with Cold bond, confirms water resistance and the bond strength.

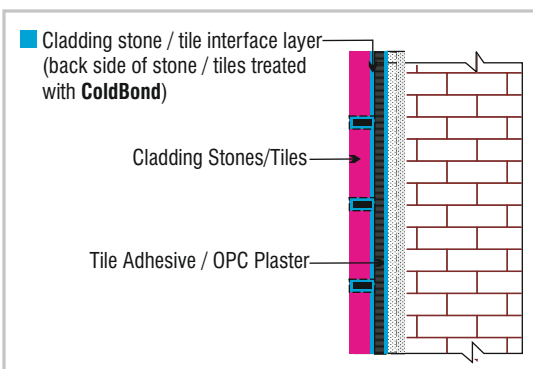

WALLS AND CLADDINGS

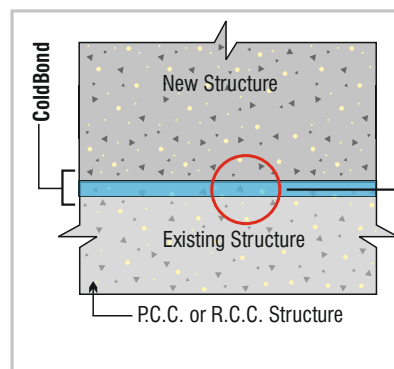

JOINTS

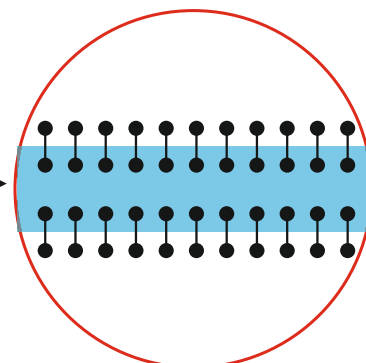

MOLECULAR LEVEL BONDING

ColdBond with 53 grade OPC conforms to IS:15477-2004 (reaffirmed to 2010) for tile adhesion, both Type-1 & Type-2

SPECIFICATIONS

Appearance	Translucent Liquid Dispersion
Viscosity at 25°C	< 50 cps
Specific gravity range	1 to 1.02
Flash Point	95 °C
Odour	Low Odour
Solubility	Easily dispersible in water
pH	Approx. 6 ± 1

PACKAGING

1, 5, 20 ltrs

SHELF LIFE

48 months when stored as recommended.

STORAGE

Store in a shaded area away from direct sunlight, between 5-45 °C. Protect from extreme temperatures.

APPLICATION

Dilute ColdBond with potable water @ 1:1. Apply by spray or brush on the tile / stone / marble / granite / joints of concrete, plaster or bricks. For wall claddings larger than 0.3 x 0.3 mtrs, use ColdBond without dilution.

COVERAGE 80-90 ft² per liter @ 1:1 dilution (may vary depending upon surface roughness)

DISCLAIMER

Whilst the information contained herein is true, accurate and represents our best knowledge and experience, no warranty is given or implied with any recommendations made by us, our representatives or distributors, as the conditions of use and the competence of any labour involved in the application are beyond our control.



Zydex Industries Pvt. Ltd. Zydex House, 61 Gotri-Sevasi Road, Gotri, Vadodara-390 021, Gujarat, INDIA

Tel : +91 265 3312000 E-mail : waterproof@zydexindustries.com Web : www.zydexindustries.com